

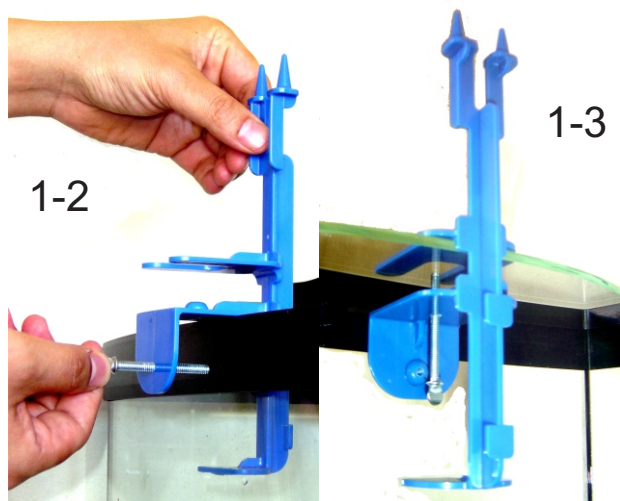

How to Use the Doradon FA18X Aquarium Acclimation System

Step 1: Aquarium frame setup

1. For most aquariums having narrow edge: Insert the *thumb screw* to *screw hole 1* of the *aquarium frame*. Place the *hook* of the *aquarium frame* on the edge of your aquarium where the *bottom support* is to stay in touch with the inner wall of the aquarium.
2. Adjust the *thumb screw* until the *aquarium frame* is almost vertical. You may hold the *frame* while adjusting the *screw* and provide some pressure so that the *screw* stays in touch with the outer wall of the aquarium.
3. For aquariums having wide edge: Insert the *thumb screw* to *screw hole 2* of the *aquarium frame*. Place the *upper support* of the *aquarium frame* over the edge of your aquarium. The *thumb screw* is adjusted so that the *frame* stays tight on the edge.



Step 2: Bag holder setup

1. Open the bag containing the specimen and pass its opening through the center orifice of the *bag holder*, allowing roughly 1 to 2 inches of the bag to pass through the *holder*. You may want to place the bag on a flat surface.
2. The *bag holder* comes with five *arrows* having sharp endings. Press a portion of the bag to the *arrow* while holding the bag tightly with your fingers so that the bag gets punctured, repeat this process for all five *arrows* while making sure that the bag is wide open and steady at the end. You may use a lower number of arrows for smaller bags. The puncturing is meant to keep the edge of the bag wrapped around the *bag holder*, and the water inside the bag should not leak out from any punctured holes.



- 
3. Hang the *bag holder* together with the bag to one of the two *holder supports* available at the *aquarium frame*. Select the position depending on the water level of your aquarium. Notice that the opening of the bag is to stay above the water level of the aquarium. This allows the water temperature inside the bag to change slowly to that of the aquarium.

Step 3: Dripping cup setup

1. Collect some water from your aquarium using the *dripping cup*. You may hold the *cup* through the *handle*.
2. Turn the *flow control valve* of the *cup* to the desired rate (Faster or slower).
3. Insert the *holes* of the *cup* to the *cup support* at the top of the *aquarium frame* allowing the water inside the *cup* to drip into the plastic bag being held by the *bag holder*. This allows the chemical properties of the water inside the bag to gradually change to that of the aquarium.

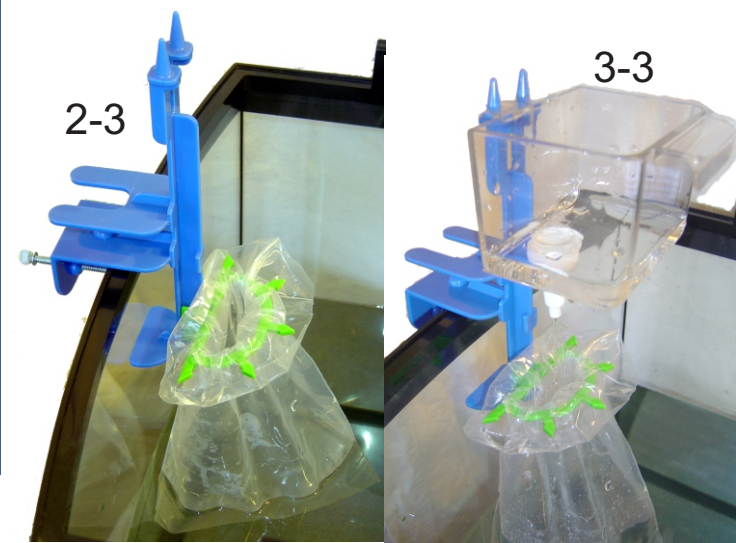

Step 4: Release and dismount

After some time – it is recommended to spend at least 15 minutes – your specimen is ready to be transferred to your aquarium. Note the following:

* Dismount the *bag holder* from the *aquarium frame* and separate the bag from its *holder*.

* In general it is not recommended to pour the transportation water inside the bag to the aquarium. Extract the specimen using a net or other device before releasing it into the aquarium.

* If you want longer acclimation time after the *dripping cup* is emptied, and if the bag has more capacity, dismount the *cup*, collect more water, and mount it back to the *aquarium frame* to continue the acclimation process. If the bag is full or nearly full, empty some of its content before refilling the *cup*.

* When you are done, rinse all parts with cold fresh water, let them dry before storage.

Further Information

Please visit www.doradon.com for product updates and additional information. Keep your acclimation system away from children.

Warranty

Your unit is guaranteed against defective workmanship and material. This guarantee does not include repair or replacement due to misuse, abuse, or normal wear and tear. This guarantee ends one year after the date of purchase.

Parts

Your acclimation kit comes with the following parts:

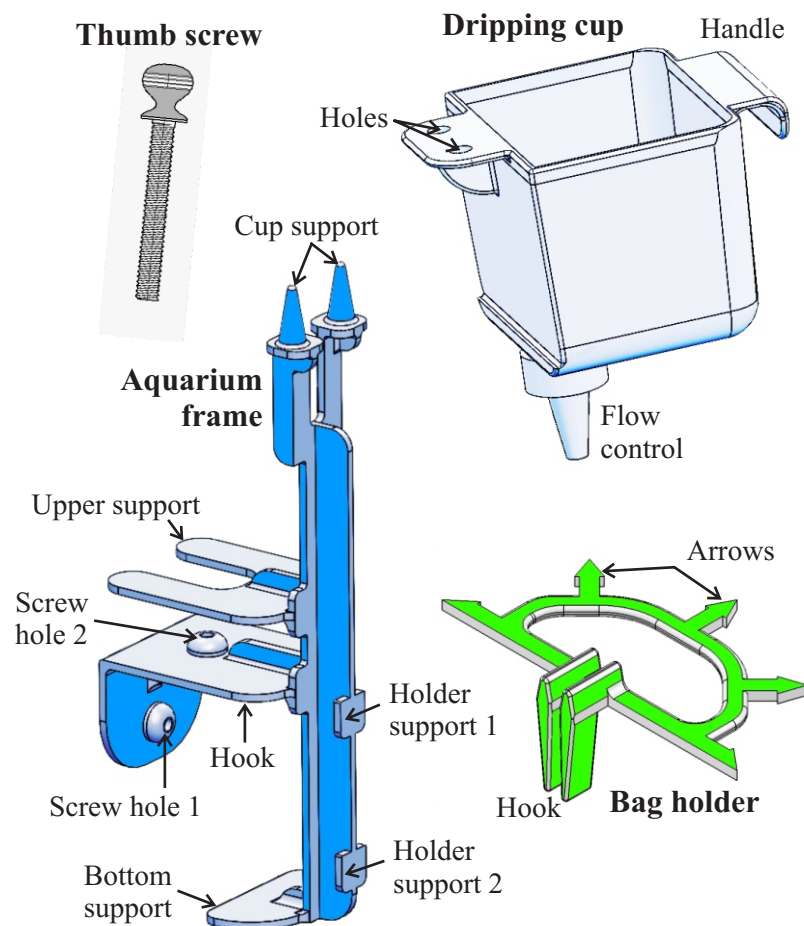

Doradon

FA18X Aquarium Acclimation System User's Guide

The FA18X aquarium acclimation system offers a simple and effective solution for the introduction of new aquatic life to your aquarium. This guide is designed to help you learn about the steps necessary to use the system effectively.

Features

- Compatible to most aquariums.
- Quick setup and dismount.
- Operates directly with the plastic bag containing the specimens.
- Selectable placement of the plastic bag at different heights depending on the water level of your aquarium.
- Selectable flow rate for dilution of the content of the plastic bag: 0 to 7 milliliter per second.
- Simultaneous equalization of temperature and chemical conditions.

